



**PSX2™**  
**(POWER STABILIZING SYSTEM)**  
**OWNER'S MANUAL**

**L I P P E R T**  
**C O M P O N E N T S®**

# TABLE OF CONTENTS

<b>Safety Information</b>	2
<b>System Description</b>	3
<b>Operation</b>	3
Preparation	3
Extending Stabilizers	3
Retracting Stabilizers	4
Stabilizing System	4
Manual Override	4
<b>System Maintenance</b>	5
Mechanical Maintenance	5
Electrical Maintenance	5
<b>Troubleshooting</b>	5

## Safety Information

The PSX2™ (Power Stabilizing System) is intended for the purpose of stabilizing the trailer. The use of this system for any reason other than which it is intended is prohibited by Lippert's Limited Warranty and may result in serious personal injury or death. The PSX2 is designed as a stabilizing component system and should not be used to provide service under the trailer for any reason, including changing tires or repairing or replacing any components beneath the trailer.

### **WARNING**

The “WARNING” symbol above is a sign that an installation procedure has a safety risk involved and may cause death or serious injury if not performed safely and within the parameters set forth in this manual. Always wear eye protection when performing this installation procedure. Other safety equipment to consider would be hearing protection, gloves, and possibly a full face shield, depending on the nature of the installation procedure.

### **WARNING**

The PSX2 is designed as a stabilizing component system. Do NOT use this stabilizing system to attempt to level the trailer. Failure to follow instructions in this manual could result in death, serious personal injury or severe product or property damage.

### **WARNING**

Lippert Components Inc. recommends that a trained professional be employed to change the tires on the trailer. Any attempts to change tires or perform other service while trailer is supported by the PSX2 could result in death, serious injury and/or damage to the trailer.

### **CAUTION**

Moving parts can pinch, crush or cut. Keep clear and use caution.

## System Description

Please read and study the Operation section of the manual before operating the PSX2. The PSX2 is a 12V DC electric motor-driven system. The electric motors drive Acme-threaded screws to extend and retract the stabilizer legs to stabilize the trailer.

The stabilizing system can be installed on travel trailers and 5th Wheels. Travel trailer options include both front and rear stabilizers or a rear stabilizer only, while 5th Wheels typically utilize only a rear stabilizer. The PSX2 has two motors per stabilizer.

There are no serviceable parts within the electric motors. If either motor fails, it must be replaced.

Disassembly of the motor voids the warranty. Mechanical portions of the PSX2 are replaceable. Contact Lippert Components, Inc. to obtain replacement parts.

## Operation

### **WARNING**

**Failure to act in accordance with the following may result in death or serious injury. Always make sure that the stabilizer area is clear of people, pets and objects before and during operation of the system. Always keep away from the stabilizer legs when operated.**

### **CAUTION**

**The PSX2 is to be used for stabilizing the trailer, not leveling the trailer. The stabilizer legs should never be extended longer than two seconds beyond initial contact with the ground.**

### **CAUTION**

**Moving parts can pinch, crush or cut. Keep clear and use caution.**

## Preparation

The PSX2 is intended for the purpose of stabilizing the trailer after the trailer has been leveled.

### **WARNING**

**Never lift the trailer completely off the ground. Lifting the trailer completely off the ground creates an unstable condition that could result in death, serious personal injury or severe product or property damage.**

1. Make sure the trailer is parked on solid, level ground.
2. Clear all stabilizer leg landing locations of debris and obstructions. Locations should be free of depressions.
3. When parking the trailer on extremely soft surfaces, utilize load distribution pads under each stabilizer leg.
4. Make sure people and pets are clear of the trailer while operating the stabilizers.

## Extending Stabilizers

1. Make sure the trailer is level.
2. Verify the battery is fully charged and hooked up to the electrical system.

**NOTE:** If the ground beneath the stabilizer is not level, it is possible that one of the stabilizer legs will reach the ground first. If this happens, continue pressing EXTEND until the second stabilizer leg reaches the ground and stabilizes the trailer.

3. Press and hold EXTEND on the switch (Fig. 1A) for the rear stabilizer until the footpads of the stabilizer legs contact the ground and the rear of the trailer is stabilized. Then release the switch.
4. If a front stabilizer is installed, press and hold EXTEND on the switch (Fig. 1A) for the front stabilizer until the footpads of the stabilizer legs contact the ground and the front of the trailer is stabilized. Then release the switch.

### **⚠ CAUTION**

**Once the stabilizer legs have been extended, do not use the tongue jack on a travel trailer or the landing gear on a 5th Wheel. Damage to the stabilizer legs can occur when lifting or leveling the trailer after the stabilizer legs have been extended. Doing so will void the warranty of the stabilizers.**

### Retracting Stabilizers

1. Verify the battery is fully charged and hooked up to the electrical system.
2. If a front stabilizer is installed, press and hold RETRACT on the switch (Fig. 1B) for the front stabilizer until the stabilizer legs are fully retracted. Then release the switch.
3. Press and hold RETRACT on the switch (Fig. 1B) for the rear stabilizer until the stabilizer legs are fully retracted. Then release the switch.

### Stabilizing System

By pressing and holding the EXTEND switch (Fig. 1A) for one to two seconds after the stabilizer legs' footpads make contact with the ground, the trailer will be stabilized and ready for use.

In the event the system shuts off while trying to stabilize the trailer, the auto-reset circuit protection contained within the motors has tripped and will reset within 10 seconds. The internal circuit protection is included to prevent the stabilizer from lifting. If the circuit protection trips, then the stabilizer legs should not be extended farther.

If the stabilizer legs are not synchronized and are extending unevenly, press and hold RETRACT (Fig. 4B) on the switch until both legs are fully retracted. The circuit protection will trip. After the circuit protection resets, the stabilization sequence can be restarted.

**NOTE:** Make sure the stabilizer legs are fully retracted before moving the trailer.

### Manual Override

The PSX2 comes with a manual override system located on the side of each motor.

### **⚠ CAUTION**

**The gears can be stripped if the stabilizer legs are manually retracted/extended to the fullest extent and the operator continues to rotate the manual override. Use of a power tool could cause harm to the user or damage the stabilizer motor.**

**NOTE:** Use a ratchet with a  $\frac{5}{16}$ " socket to manually override the system. Do not use a power tool to perform any of the override procedures since this may damage the motor.

To manually operate the stabilizers:

1. Disconnect one of the wire leads from each motor to prevent backfeeding the motors.

**NOTE:** The manual override procedure must be performed individually on each motor of PSX2 in order to manually extend or retract the legs.

2. Find the access port on the side of the leg motor (Fig. 2A).

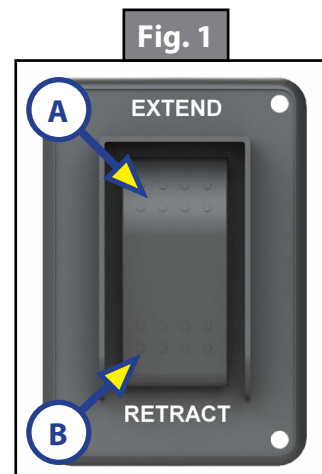

- 3. Remove the rubber plug.
- 4. Place the 5/16" socket over the manual override nut (Fig. 2A).
- 5. Turn the override nut until the leg extends or retracts to the desired position. A clockwise rotation will extend the leg and counterclockwise will retract the leg.

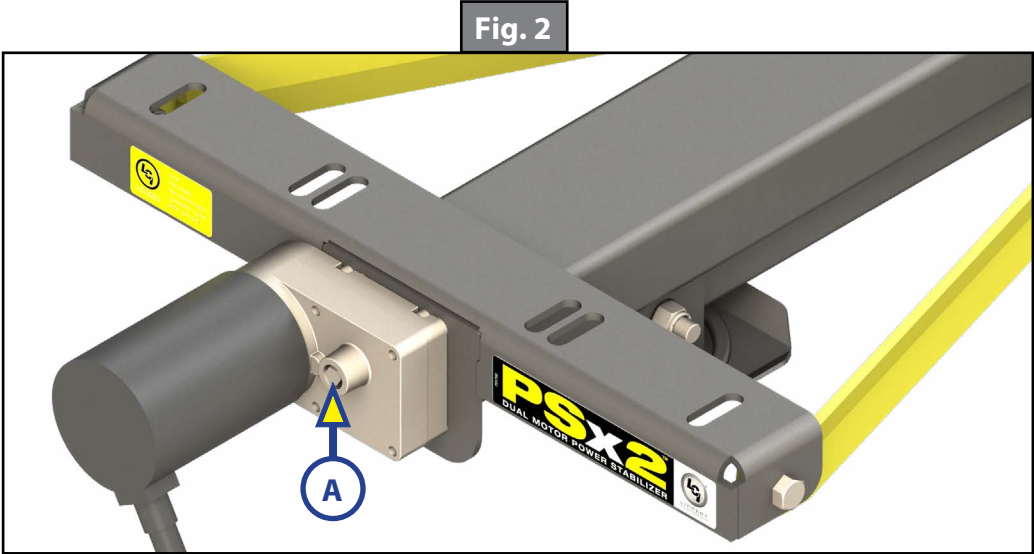

System Maintenance

**⚠ WARNING**

**Do not work on the stabilizer unless the battery is disconnected. Failure to act in accordance with the following may result in death, serious personal injury or severe product or property damage.**

Mechanical Maintenance

It is recommended that when operating in harsh environments, e.g. road salt or ice buildup, the moving parts be kept clean. They can be washed with mild soap and water. The ACME screw is pre-coated with grease. If the screw is cleaned, it may be necessary to add grease to the screw to ensure smooth stabilizer operation.

Electrical Maintenance

For optimum performance, the system requires full battery current and voltage. Maintain battery at full capacity. Also, check the terminals and other connections at the battery, the control switch and the electric motors for corrosion and loose or damaged terminals. Check motor leads under the trailer chassis. Since these connections are subject to damage from road debris, make sure they are in good condition.

Troubleshooting

What Is Happening?	Why?	What Should Be Done?
Legs out of sync	Uneven ground.	Fully retract both stabilizer legs to synchronize.
	Stabilizer legs extended unevenly.	
System shuts off	Too much weight.	Internal circuit protection will reset in 10 seconds.
Switch does not activate system	Low voltage.	Test battery voltage under load. Charge or replace.
	Damaged or disconnected wiring.	Check wiring. Repair or replace.



# L I P P E R T C O M P O N E N T S®

The contents of this manual are proprietary and copyright protected by Lippert Components, Inc. ("LCI"). LCI prohibits the copying or dissemination of portions of this manual unless prior written consent from an authorized LCI representative has been provided. Any unauthorized use shall void any applicable warranty. The information contained in this manual is subject to change without notice and at the sole discretion of LCI.

Revised editions are available for free download from [lci1.com](http://lci1.com).

Please recycle all obsolete materials.

For all concerns or questions, please contact  
Lippert Components, Inc.

Ph: (574) 537-8900 | Web: [lci1.com](http://lci1.com) | Email: [customerservice@lci1.com](mailto:customerservice@lci1.com)